



## Belmore Apartments

Harrow

£449,999

A two double bedroom flat available chain free and in excellent condition, Davidson Frost-Wellings.

Available with an open plan kitchen / living room with wooden floors, large windows and a spacious covered balcony. There are two double bedrooms and a large family bathroom. The flat is South facing and is flooded with natural lights, comes with a gated parking space with CCTV, and is covered by the New Home Guarantee.

Belmore Apartments is in an excellent location for an array of shops and transport links around Belmont Circle and is well positioned to reach Central London in 20 minutes from Canon's Park tube station.

Leasehold with approximately 120 years remaining.

Ground Rent nil.

Service Charge of £1,883.99.

Harrow Council Tax Band D.

### Viewing

Please contact our Davidson Frost-Wellings Office on 020 8954 8806 if you wish to arrange a viewing appointment for this property or require further information.

- Two Bedrooms
- Open Plan Kitchen
- Large Covered Balcony
- Chain Free
- Gated Parking Space
- New Build Guarantee



2



1



1



B



Floor Plan

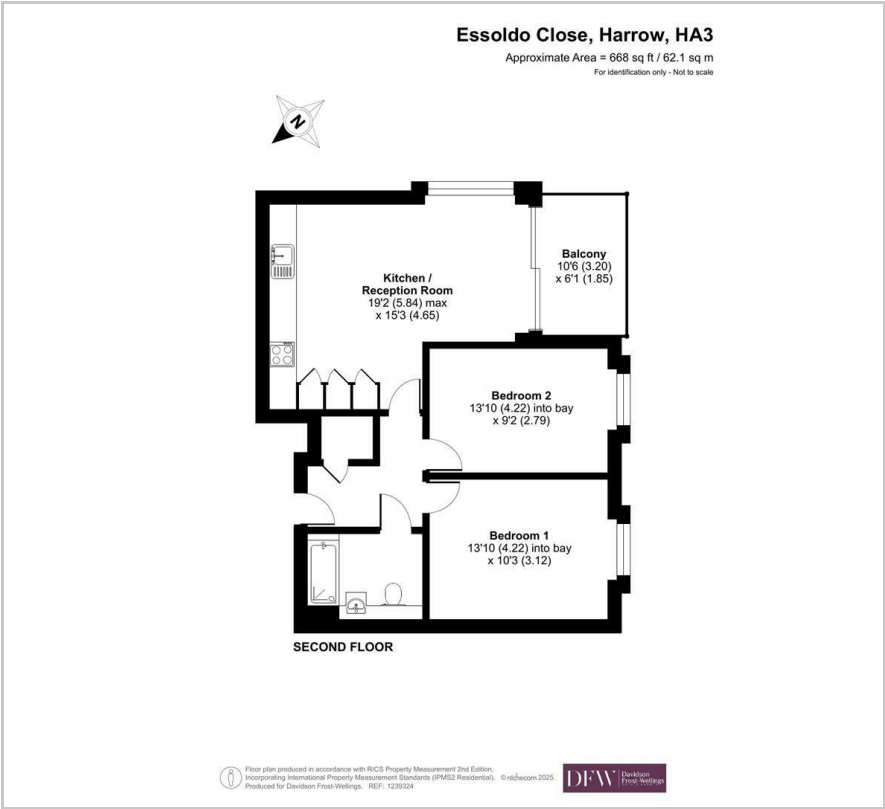

Area Map

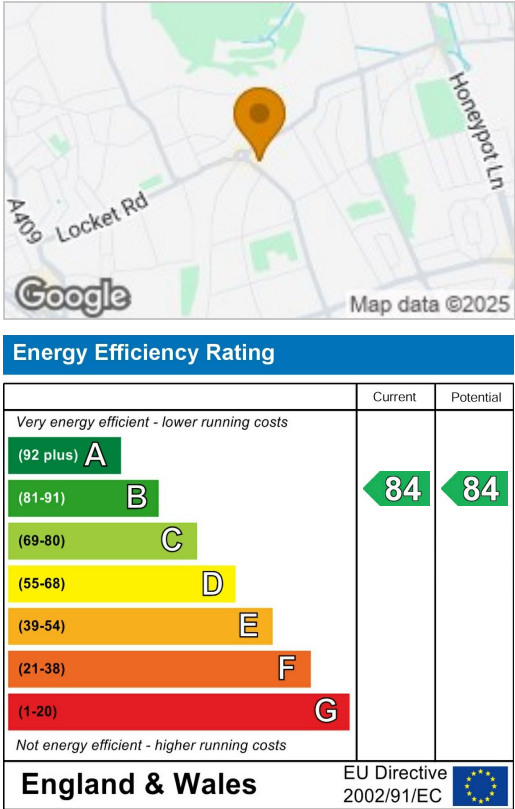

These particulars, whilst believed to be accurate are set out as a general outline only for guidance and do not constitute any part of an offer or contract. Intending purchasers should not rely on them as statements of representation of fact, but must satisfy themselves by inspection or otherwise as to their accuracy. No person in this firms employment has the authority to make or give any representation or warranty in respect of the property.